



SAMMAMISH RETREAT

5002 190TH PL NE | SAMMAMISH 98074



SAMMAMISH RETREAT

SAMMAMISHRETREAT.COM

Nestled in the tranquil community of Eastlake Sammamish, this meticulously updated home presents an oasis of peace with breathtaking vistas of Lake Sammamish. A winding driveway leads you through illuminated mature landscaping leading to the welcoming entrance of the home.

From the sunlit front decks to the heart of the home, the kitchen, seamless transitions lead to a private back patio retreat featuring stone-paving and hot tub, perfect for relaxation. A tranquil water feature, accented with optional multi-color lighting adds a touch of magic to the surroundings. The primary bedroom boasts sweeping lake views and a private deck overlooking the expansive estate-like grounds. Large 5-piece bathroom with soaking tub and glass-enclosed shower with dual rain-showers.

This home can be your leaping off point for all things fun on Lake Sammamish with a private community beach featuring docks, boat slips, a water trampoline and a shady gazebo overlooking the sandy beach. Award-winning schools: Blackwell Elementary, Inglewood Middle School and Eastlake High. The immaculate 3-car garage is ready for the most selective of shop enthusiasts. Ample storage, a workshop, 220 EV charging, and a convenient half bath. Additional features include: A/C, a dog run, and plentiful off-street, boat, and RV parking.

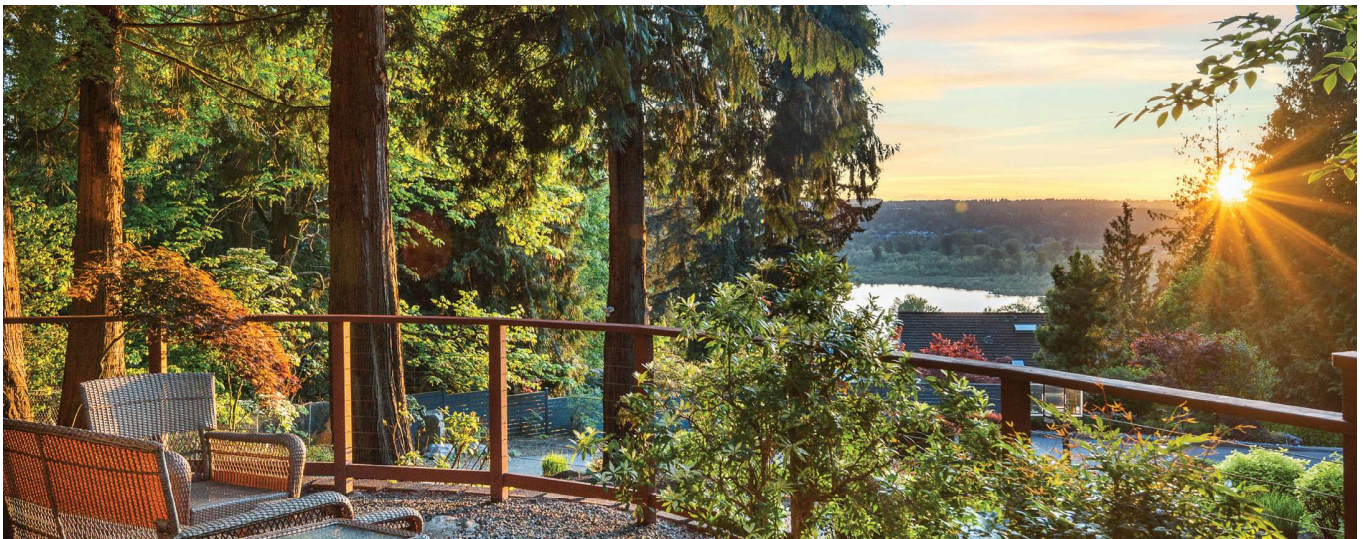



5 BEDROOMS

2.75 BATHROOMS

SQFT: 3,492

LOT SIZE: 19,036 SF

YEAR BUILT: 1992

2 GAS FIREPLACES

GARAGE SQFT: 1,049

MLS# 2235690



SAMMAMISH RETREAT

5002 190TH PL NE | SAMMAMISH 98074

INTERIORS

- Double entry doors
- Dramatic 2-story Entry
- Vaulted ceilings and skylights
- Formal living room with vaulted ceiling and views
- Designer-stained oak hardwood floors
- Two gas fireplaces
- New wall-to-wall carpeting
- Multiple sets of french doors
- White kitchen with quartz island with seating
- Stainless steel appliances
- Walk-in pantry
- Dining space with views
- Primary bedroom with vaulted ceilings and private deck
- Primary bathroom with soaking tub, tile floors & updated fixtures
- Dedicated office overlooking water feature
- Tiled laundry room with quartz countertop and sink

EXTERIORS

- Mature up-lit landscaping with water feature
- Multiple entertaining decks and patios
- Wood siding
- Composition architectural grade roof
- Hot tub
- Multiple outside gas stubs
- Parking for boat, RV and guests

SYSTEMS

- Forced-air heating
- 7-Zone sound system
- Air-conditioning throughout
- Gas fireplace on main floor
- Two-sided gas fireplace in primary bedroom and bathroom
- Large main floor TV stays with the home
- Central vacuum system

LOCATION

- End of quiet street above cul-de-sac
- Private 28-home community "Sammamish View Park"
- Private community beach with 70 ft. of waterfront, 2 docks and \$200/yr moorage (current 1-person waitlist)
- Easy access to East Lake Sammamish Trail
- Minutes from 520, Downtown Redmond and tech corridor
- Minutes to Costco, Whole Foods, Target, Home Depot, restaurants and more
- Prime close-in Sammamish location



BRITT WIBMER

LUXURY REAL ESTATE

SAMMAMISHRETREAT.COM





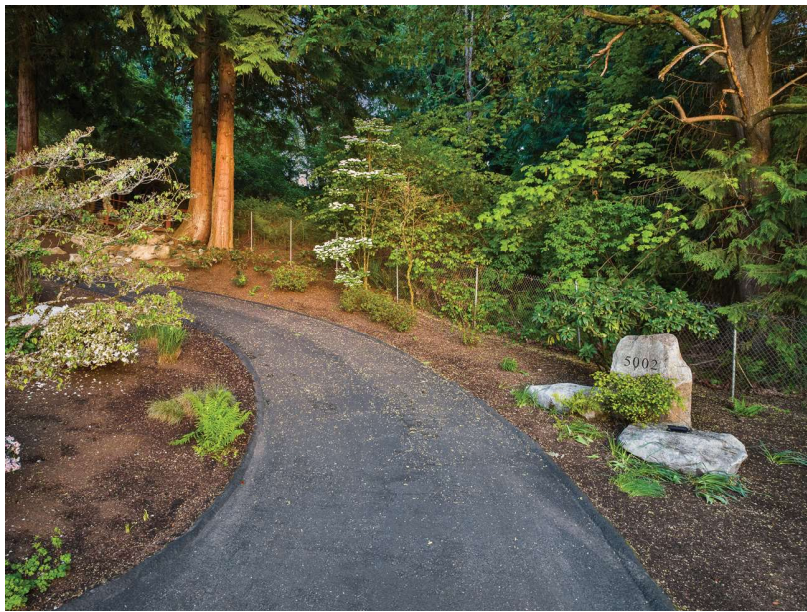
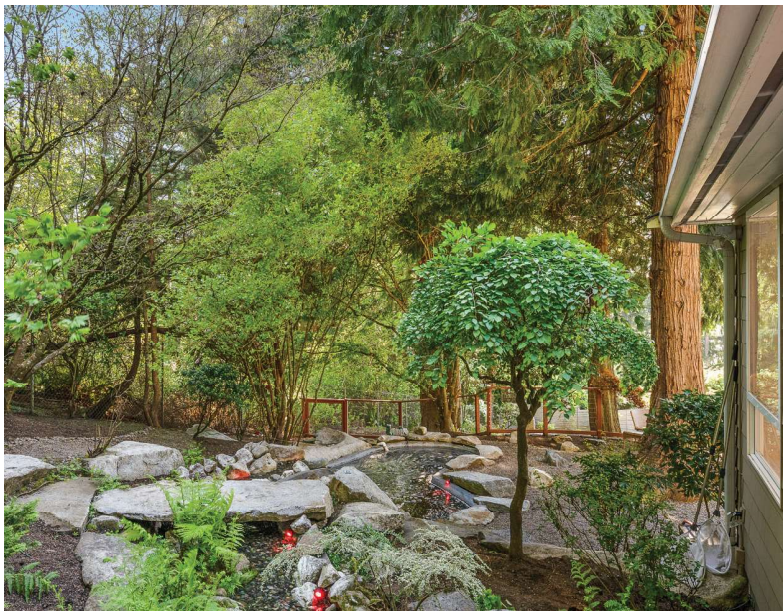



BRITT WIBMER

LUXURY REAL ESTATE



SAMMAMISHRETREAT.COM



BRITT WIBMER

Britt@Windermere.com

BrittWibmer.com

206.683.1737



Windermere Real Estate/East, Inc.
3933 Lake Washington Blvd NE Suite 100 | Kirkland, WA 98033